

SERVICE LETTER SL48 65-45104

1. Release Date: 03/22/2021
2. Service Letter No.: SL48 65-45104
3. Subject: Gravel Deflector
4. Part/Assembly No.: 65-45104
5. Float Model Affected: 6650
6. Compliance: **Mandatory** **Recommended** **Optional**
7. Approval: All information provided is in accordance with approved data.
8. Corrective Action: Non-required.
9. Time Required: **Approximately 1 hour.**
10. Payments: Credit to Customer Under Warranty Customer Pays

Customers have requested a gravel deflector for protecting brake bleeders when operating on unimproved landing strips. We are happy to announce they are now in stock and ready to order.

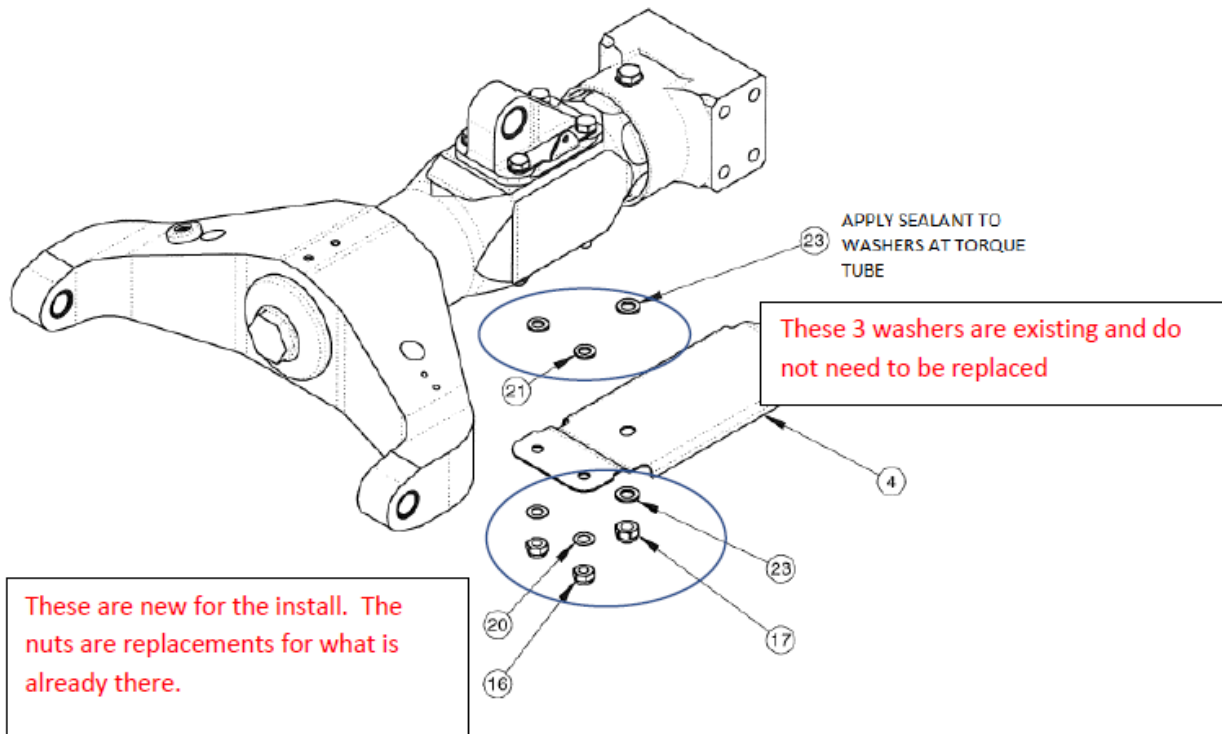

NOTE CHANGES ON DRAWING

Note 7 (NEW):

- 7. OPTIONAL INSTALLATION OF 65-45104 DEFLECTOR IN ACCORDANCE WITH SHEET 4 OF THIS DRAWING. ASSEMBLY NUMBER WITH THIS DRAWING IS 65-4510-2

Note 8 (NEW)

- 8. 65-45100 LOWER MAIN GEAR ASSEMBLIES SHOWN WITH RIGHT HAND SIDE VERSION SHOWN UNLESS OTHERWISE NOTED. POSITION ZINC ANODE TO THE OUTBOARD SIDE.

Note 7 introduces the dash number designating inclusion of the deflector. Note 8 clarifies assembly orientation. The only difference between LH and RHS is the position of the sacrificial anode.)

PARTS KIT FOR 65-17190 LSP CABLE INSTALLATION (MLG)					
ITEM NO.	QTY	TYPE	PART NUMBER	DESCRIPTION	COMMENTS ALTERNATIVES
4	1	PART	65-45104	DEFLECTOR, LOWER MAIN GEAR ASSEMBLY	
16	2	HRDWR	MS21044N5	NUT, SLEF LOCKING, REGULAR HEIGHT	
17	1	HRDWR	MS21044N6	NUT, SLEF LOCKING, REGULAR HEIGHT	
20	2	HRDWR	NAS1149D0516K	WAHSER, FLAT	
23	2	HRDWR	NAS1149D0663K	WASHER, FLAT	

Rev	Date	Summary of Change	Authorized by
I/R	03/22/2021	Initial Release	LM

-END-