

SERVICE LETTER SL35 65-45000 Rev A

This Service Letter has been superseded by SL54 65-45000



1. **Release Date:** 10/05/2018
2. **Service Letter No.:** SL35 65-45000 Rev A
3. **Reason for Change:** Improve spring retention in case of breakage and improve manufacturing and assembly.
4. **Part/Assembly No.:** 65-45000
5. **Float Model Affected:** 6650
6. **Disposition of Product in Field:** Recommended
7. **Approval:** All information provided is in accordance with approved data.
8. **Corrective Action:** Replace hardware to retain main landing gear spring.
9. **Time Required:** Under 1 hour
10. **Payments to customer:** None. Call (208) 448-0400 for Parts Department

NOTE: This revision is to clarify the need for spacers at both the upper and lower spring bracket.

Instructions:

1. Replace MS51957 flat washer (or MS 15795-852) with 35-80058 extension spring spacer (new). See Figure 1 page 2.
2. Replace spring bushing attach bolt AN4-11 (or AN4-14A) with 35-80060 corrosion resistant, extended thread bolt (new). See Figure 2 page 3.

Parts Kit

Item No.	Qty Per Float	Type	Part Number	Description
9	4	PART	35-80058	SPACER, EXTENSION SPRING
10	2	PART	35-80060-11	BOLT, CORROSION RESISTANT, EXTENDED THREADS
11	2	PART	35-80060-13	BOLT, CORROSION RESISTANT, EXTENDED THREADS
12	4	PART	35A-45035	SPRING BUSHING
15	2	PART	35A-45095	EXTENSION SPRING
41	4	HRDWR	AN316C4R	JAM NUT, STAINLESS, RH THREADS
47	4	HRDWR	MS17825-4	NUT, SELF-LOCKING, CASTELLATED, NON-METALLIC INSERT
53	4	HRDWR	MS24665-153	COTTER PIN
59	8	HRDWR	NAS1149C0416R	WASHER, FLAT, STAINLESS
60	4	HRDWR	NAS1149C0463R	WASHER, FLAT, STAINLESS

NOTE SPRING ORIENTATION
ALLOWING WIND OF SPRING
BODY GREATEST CLEARANCE
TO THE OUTSIDE
LHS AND RHS ARE OPPOSITE
ORIENTATION

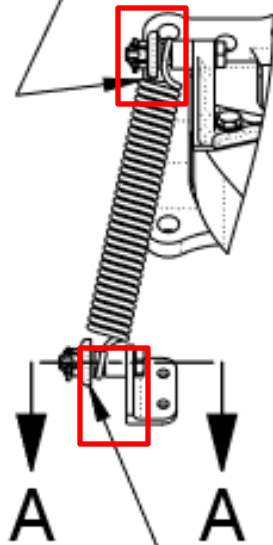

35-80058 SPACER
ORIENTED WITH CUP
FACING TO INSIDE

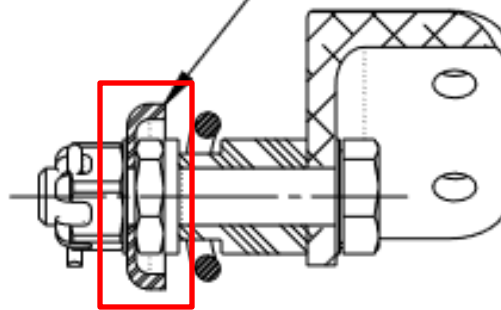

SECTION A-A

Figure 1 Extension Spring Spacer

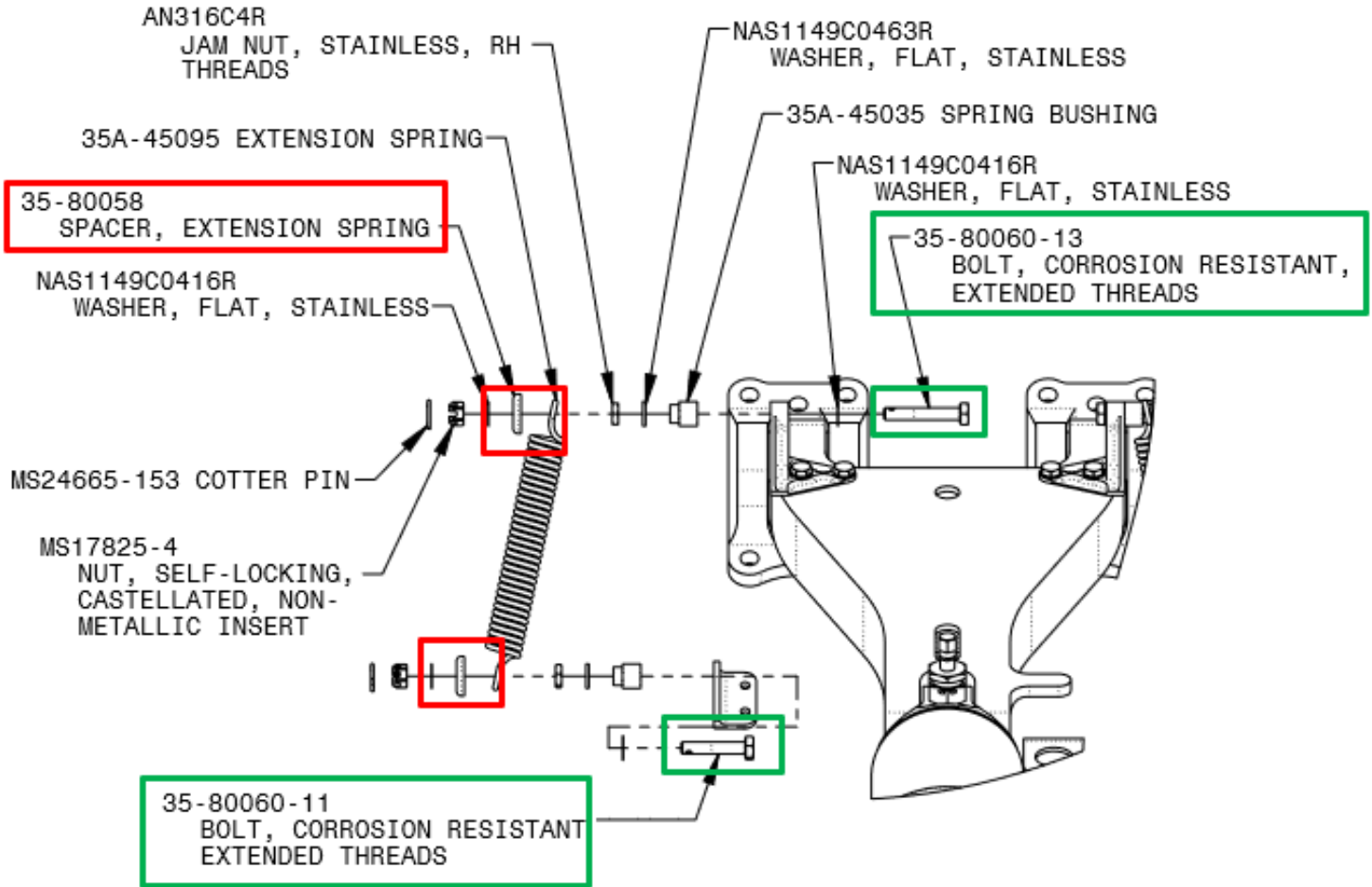

Figure 2 - Full View New Extension Spring Spacers (Red) and Corrosion Resistant Bolts with Extended Threads (Green)

Rev	Date	Summary of Change	Authorized by
I/R	08/16/2018	Initial Release	LM
A	10/05/2018	Added revision record.	LM