



Service Letter #: SL18 66-47200

Initial Release Date: October 14, 2016

66-47201 Side, Left, Hydraulic Pedestal

66-47400 Rudder Retract Handle

Float Model Affected: New product serial numbers: 6650 Float Serials 158-159 and following. Existing product serial numbers: 6650 Float Serials 156-157 and previous.

Disposition of Product in Field: Replacement is optional.

Approval: All information provided is in accordance with approved data.

Affected: Parts and Assemblies, Illustrated Parts Catalog.

Symptom: Existing fasteners causing cosmetic scratches on arm of rudder retract handle and pedestal side.

Corrective Action: Replace washer head screws with countersunk type screws.

Time Required: Under one hour

Description of Change:

Side Left, Hydraulic Pedestal 66-47201

1. Apply countersink to thru holes as shown

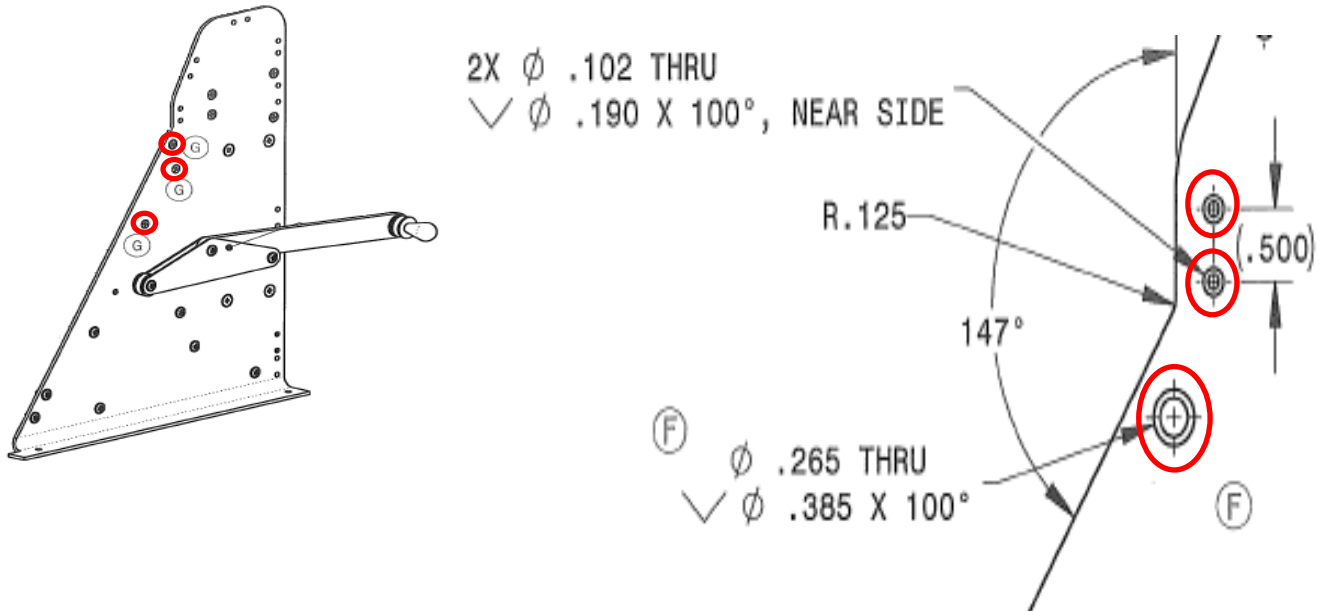

2. De-bur and apply chemical conversion coating to bare surfaces, Use Alodine 1132 Touch 'N Prep Pen or Alodine 1201.
3. Replace AN525 washer head screws with MS24694 flathead screws at 3 locations on left side.

Parts List				
Item No.	Quantity	Type	Part No.	Description
1	3	Hardware	MS24694S50	Machine Screw, Flat, Countersunk head, 100°

Part 66-47400 - Rudder Retract Handle:

Replace washer-head screw on rudder retract handle with flathead screw.

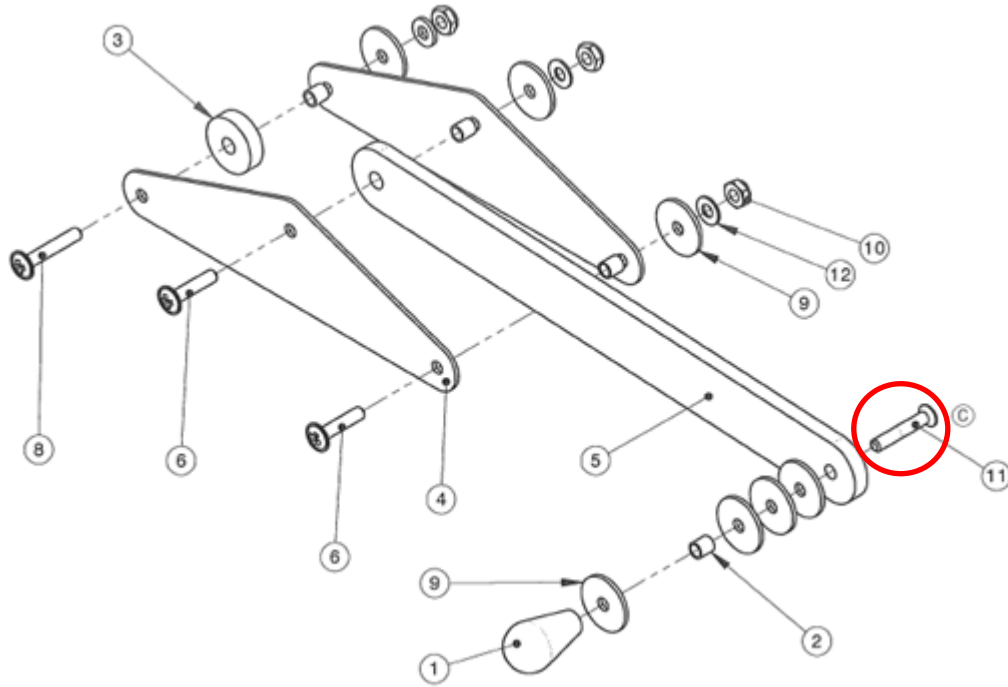

Parts List				
Item No.	Quantity	Type	Part No.	Description
1	1	Hardware	MS24694S59	Machine Screw, Flat, Countersunk head, 100°

REVISION RECORD

Rev	Date	Summary of Change	Authorized by
I/R	10/14/2016	Initial Release	LM
A	10/17/2017	Added release date	LM
B	03/21/2020	Added Revision Record	

-END-